

# Pilot RC CF landing gear detail list

model type	A (MM)	B (MM)	C (MM)	D (MM)	E (MM)	F (MM)	G (MM)	H (MM)	I (MM)	J (MM)	K (MM)	L (MM)	mounting hole (MM)	hole for axle (MM)	hole for pants (MM)	holes for gear cover (MM)
YAK54-53	105	90	285	20	57	0	0	6	11	0	165	10	∅4.2	∅4	∅2.2	0
YAK54-73;YAKM55-73	140	131.5	403	30	100	16	0	10	0	0	195	19	∅4.2	∅8.2	0	0
EDGE540V3-67	140	131.5	403	30	89	20	0	10	0	0	195	19	∅3.2	∅6.2	0	0
YAK54-87;YAKM55-88	158.8	138.1	435	40	98.2	26.3	0	10	0	0	218	24	∅4.2	∅8.2	0	0
PITTS-73	158.8	138.1	435	40	118	26.1	0	10	18	12	218	24	∅4.2	∅8.2	∅3.2	0
SBACH342-87	158.8	138.1	435	40	98.2	26	0	10	18	12	218	24	∅4.2	∅8.2	∅3.2	0
YAK54-107;YAKM55-107	207.2	228	663	50	154	30	0	12	0	0	260	29	∅6.2	∅8.2	0	0
LASER-103; SLICK-103	207.2	228	663	50	147.6	28	0	12	18	16.5	260	29	∅6.2	∅8.2	∅3.2	0
PITTS-87	207.2	228	663	50	148	30	0	12	18	16.5	260	29	∅6.2	∅8.2	∅3.2	0
YAK54-121	211.5	264	740	50	158.5	31.5	0	12	0	0	287	30	∅6.2	∅8.2	∅3.2	0
YAKM55-122	215	232.5	680	60	158.5	31.5	0	14	0	0	252	29.5	∅6.2	∅8.2	0	0
PITTS-106	215	232.5	680	60	158.5	31.5	0	12	20	12	250	29.5	∅6.2	∅8.2	∅3.2	0
YAK54-129;YAK54-148	250	281	812	65	194.4	40	0	16	0	0	410	33	∅6.2	∅8.2	0	0
YAK54-180	348	266	880	68	215.6	40	170	18	0	0	400	35	∅6.2	∅8.2	0	∅3.2
DECATHLON-180	348	266	880	68	207	40	170	18	0	0	410	35	∅6.2	∅8.2	0	∅3.2
EDGE540-73;EDGE540V2-74;EDGE540V3-78;EXTRA260-73; SBACH342-73;SKY-WOLF-88;LASER-73	164.8	117.1	399	35	100	16	0	13	13	13	162.8	24.5	∅4.2	∅8.2	∅3.2	0
LASER-67	164.8	117.1	399	35	89	20	0	13	13	13	162.8	24.5	∅3.2	∅6.2	∅3.2	0
EXTRA260-87;EDGE540-87	196.2	138.4	473	40	98.2	26	0	10	18	12	218	24	∅4.2	∅8.2	∅3.2	0
DECATHLON-107	196.2	138.4	473	40	98.2	25	64.3	10	18	12	218	24	∅4.2	∅8.2	∅3.2	∅3.2
EDGE540V3-92;LASER-88	196.2	138.4	473	40	137	26	0	10	18	12	218	24	∅4.2	∅8.2	∅3.2	0
EXTRA260-106;EDGE540-107;EDGE540V3-107	237.9	216.05	670	50	137.6	30	0	12	20	16.5	230	26	∅6.2	∅8.2	∅3.2	0
DECATHLON-122	237.9	216.05	670	50	120.4	24	86.5	12	20	16.5	230	26	∅6.2	∅8.2	∅3.2	∅3.2
KATANA-106	237.9	216.05	670	50	120.4	24	0	12	20	16.5	230	26	∅6.2	∅8.2	∅3.2	0
SBACH342-107	237.9	216.05	670	50	167.6	28	0	12	20	16.5	230	26	∅6.2	∅8.2	∅3.2	0
EXTRA260-122;EDGE540-122;EDGE540V3-122; SBACH342-122;KATANA-122	266.8	221.6	710	60	165.6	35	0	12	20	12	255	29.5	∅6.2	∅8.2	∅3.2	0
SKYLINE182-150	266.8	221.6	710	60	165.6	35	130	12	20	12	255	29.5	∅6.2	∅8.2	∅3.2	∅3.2
EXTRA330SC-60	140	90	320	29	79	14	0	8	9	7.5	140	13	∅3.2	∅4	∅3.2	0
EXTRA330SC-67	134	111.5	357	30	89	20	0	9	10	11	150	18	∅3.2	∅6.2	∅3.2	0

# Pilot RC CF landing gear detail list

model type	A (MM)	B (MM)	C (MM)	D (MM)	E (MM)	F (MM)	G (MM)	H (MM)	I (MM)	J (MM)	K (MM)	L (MM)	mounting hole (MM)	hole for axle (MM)	hole for pants (MM)	holes for gear cover (MM)
EXTRA300-73;EXTRA330SC-73;EXTRA330SC-78; EXTRA330LX-78;EXTRA NG-78	145	123.5	392	29.5	100	16	0	9	11	9.5	174	20.5	∅4.2	∅8.2	∅3.2	0
EXTRA300-88;EXTRA330SC-88	160	157	474	40	119	20	93	12	12	12	210	23	∅4.2	∅8.2	∅3.2	∅3.2
EXTRA330SC-92;EXTRA330LX-92;EXTRA NG-90	160	157	474	40	137	20	0	12	12	12	210	23	∅4.2	∅8.2	∅3.2	0
EXTRA300-107;EXTRA330SC-107;EXTRA330LX-107; EXTRA330LX-103;EXTRA NG-103	193	183.5	560	50	147.6	28	0	12	20	12	254	30	∅6.2	∅8.2	∅3.2	0
EXTRA300-122;EXTRA330SC-122	230	217.5	665	53	165.6	28	0	13	15	17	266	30	∅6.2	∅8.2	∅3.2	0
SBACH342-53	105	75	255	20	57	0	0	6	10	0	128		∅3.2	∅4	∅2.2	0
DECATHLON-150	286	250	786	65	167.6	39	132.1	14	20	21.6	331	40	∅6.2	∅8.2	∅3.2	∅3.2
SBACH342-148	286	250	786	65	216	39	0	14	20	21.6	331	40	∅6.2	∅8.2	∅3.2	0

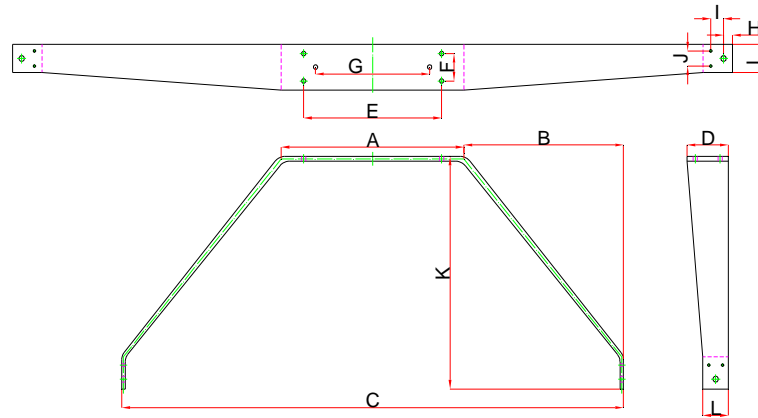

制表: 钟福贤

日期: 2020-6-12

审核:

日期: